



Robot

User Manual

This product uses 2 "AA" and 3 "AAA" batteries.

WARNING! Always use under direct adult supervision. For use by ages **3** and up. Please read instruction booklet carefully before operating **Robot**. Please keep instruction booklet and display box for future reference.

Any Questions?

Email our Customer Service Dept.: customerservice@kidgalaxy.com

Call our Customer Service Dept.: Kid Galaxy Customer Service, Toll Free 1-800-816-1135

INTRODUCTION

My First RC **Robot** is one very cute character! With its two button easy control, your Robot will go forward and turn while emitting colorful flashing lights in its dome. Robot also produces a playful techno-sound! For best performance, always aim the controller directly at My First RC **Robot**. My First RC **Robot** is for indoor use only!

CONTROLLER

- Unscrew the battery cover on the backside of the handheld controller with a Philips screw driver.
- Insert 2 "AA" batteries with polarities as shown inside battery compartment.
- Replace battery cover and screw shut.

ROBOT

- Unscrew the battery cover on the **Robot's** bottom with a Philips screw driver.
- Insert 3 "AAA" batteries with polarities as shown inside battery compartment.
- Replace battery cover and screw shut.

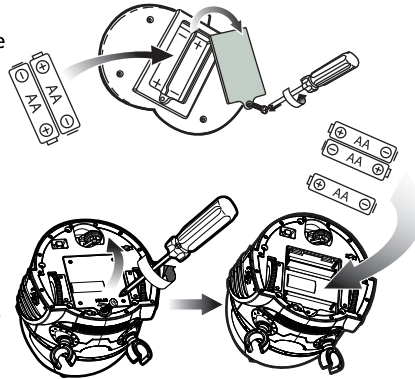

OPERATION

- Turn **Robot** over and slide the switch to the "on" position. Note that the sound can be switched "on" or "off" as desired.
- Press the left button on the controller, the **Robot** will do move forward.
- Press the right button on the controller, the **Robot** will turn until you release the button.

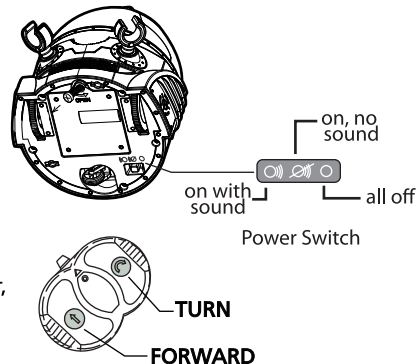

WARNING!

PLEASE READ THIS CAREFULLY BEFORE USING.

- Do not mix old and new batteries.
- Do not mix alkaline, standard (Carbon-Zinc), or rechargeable (ni-Cad) batteries
- Battery insertion must be done by an adult.
- Do not short circuit battery contacts.
- Dispose of batteries safely and correctly.
- Do not attempt to burn batteries. Remove exhausted batteries.
- Remove batteries if the product will not be used for a long period of time.
- After play, move switch to "off" position to extend battery life.
- If your Robot becomes stuck under furniture, always ask an adult for help to retrieve it.
- When you are operating your Robot, always keep it in your sight.
- Keep your hair and clothing away from the spinning wheels.
- There are small parts included in this product. Do not put any of the parts in your mouth.
- Keep away from fire or hot and/or humid environments.
- Do not disassemble the product.
- Do not use other chargers with your product. Doing so will damage your Robot!

FCC REQUIREMENT

1. This device complies with Part 15 of the FCC Rules. Operation is subject to the following two conditions: (1) this device may not cause harmful interference, and (2) this device must accept any interference received, including interference that may cause undesired operation.

NOTE: This equipment has been tested and found to comply with the limits for a Class B digital device, pursuant to part 15 of the FCC Rules. These limits are designed to provide reasonable protection against harmful interference in a residential installation. This equipment generates, uses and can radiate radio frequency energy and, if not installed and used in accordance with the instructions, may cause harmful interference to radio communications. However, there is no guarantee that interference will not occur in a building installation. If this equipment does cause harmful interference to radio or television reception, which can be determined by turning the equipment off and on, the user is encouraged to try to correct the interference by one or more of the following measures:

- Reorient or relocate the receiving antenna.
 - Increase the separation between the equipment and receiver
 - Connect the equipment into an outlet on a circuit different from that to which the receiver is connected.
 - Consult the dealer or an experienced radio/TV technician for help.
2. Caution: changes or modifications not expressly approved by the party responsible for compliance could void the user's authority to operate the equipment.

KID GALAXY INC. LIMITED WARRANTY

Kid Galaxy's products are covered under a limited 60 day warranty against manufacturer defects. If a product is deemed defective and falls within the 60 day period, Kid Galaxy will repair or replace it at no charge. We require a copy of the original sales receipt to validate the purchase. Product must be purchased within US or Canada to be eligible.

Please email us at: customerservice@kidgalaxy.com or call us!

Toll Free Hot Line: 800-816-1135

www.kidgalaxy.com

WARNING:
CHOKING HAZARD—Small parts
Not for children under 3 years.

Kid Galaxy, Inc. 150 Dow St., Ste. 425B,
Manchester, NH 03101
Product Manufactured In China

Kid Galaxy
★ ★ ★

Copyright 2011 © Kid Galaxy, Inc.